

Schoolhouse (horizontal)



Blocksize: 6 x 14 inch



© Claudia Hasenbach 2014
Nußbaumerstraße 292
D - 50825 Köln

www.claudias-quilts.com
email: pattern@claudias-quilts.com

Artwork by www.graphicgarden.com

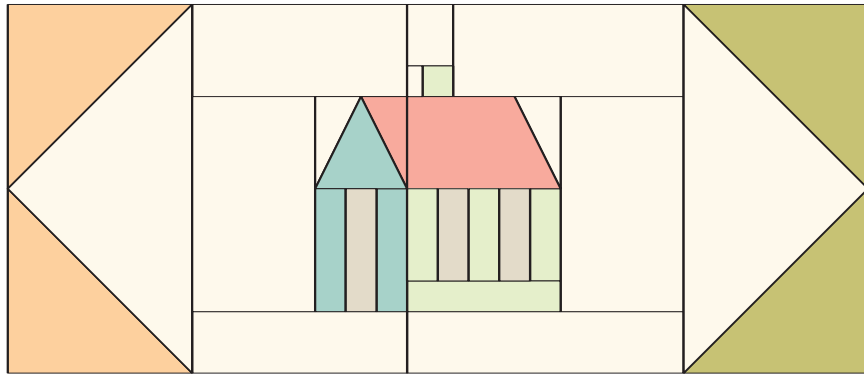

background



schoolhouse



star spikes

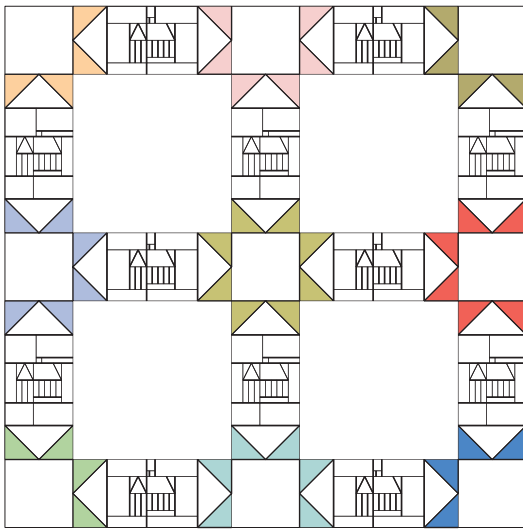

Attention! You have to plan the colors of the star's spikes. Joining the quilt top only spikes with the same color must meet.

Alternatively you can work one unit more (see page 5) and attach the stars points later, for example while assembling the top.



Sewing order:

1. B + C
2. A + BC
3. ABC + D

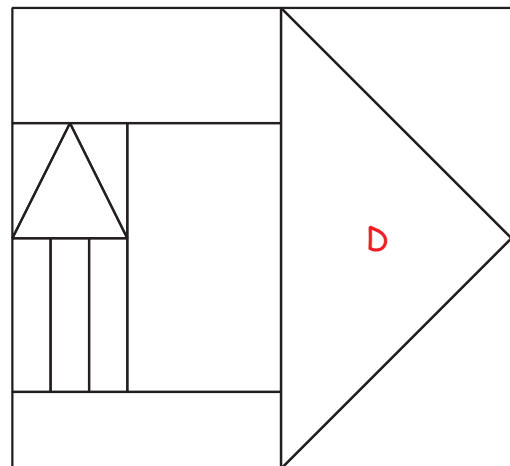
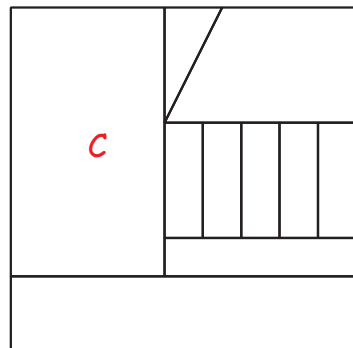
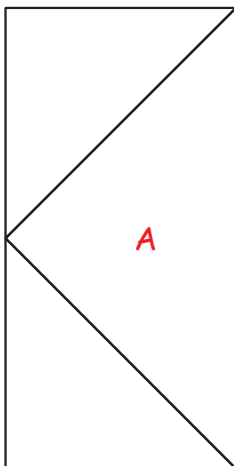

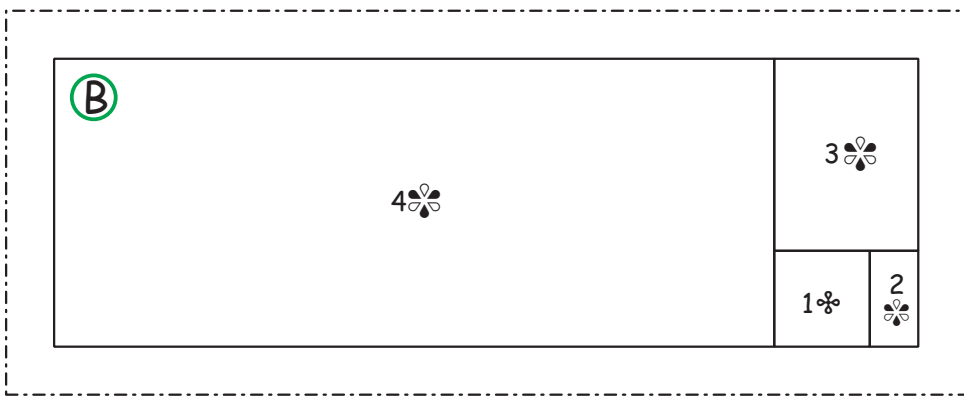
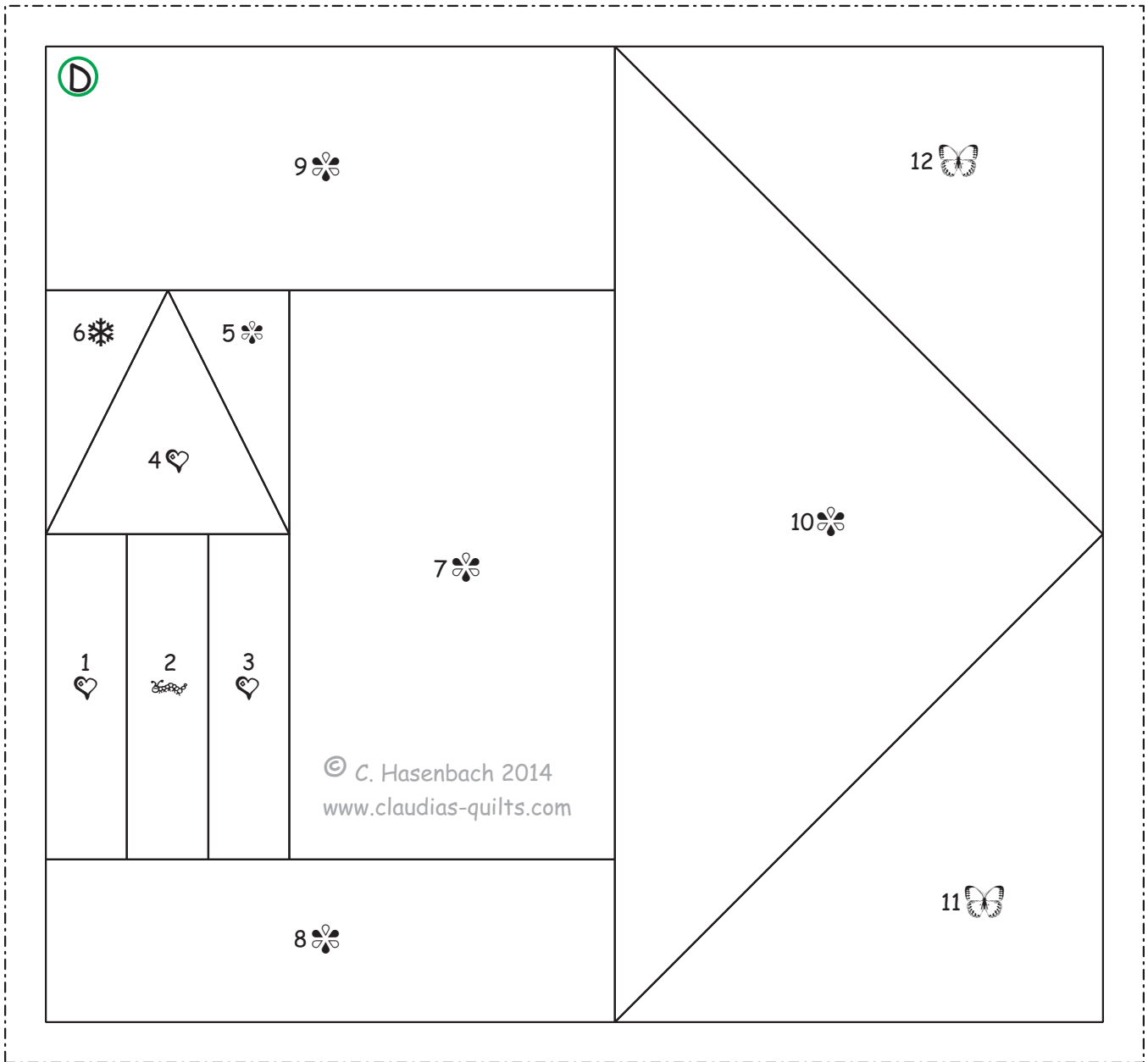

Schoolhouse
 (horizontal)
 pp-pattern 1/2

1 inch
 please
 measure after
 printing!

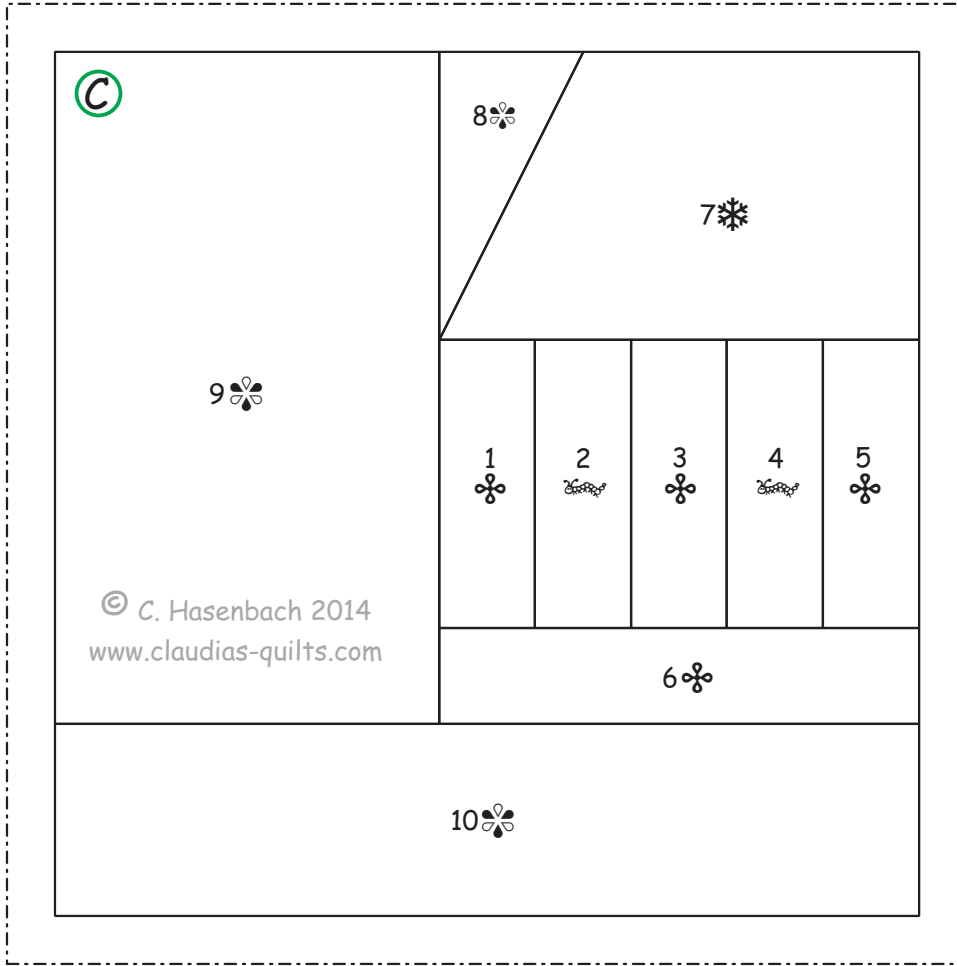

Schoolhouse
(horizontal)
pp-pattern 2/2

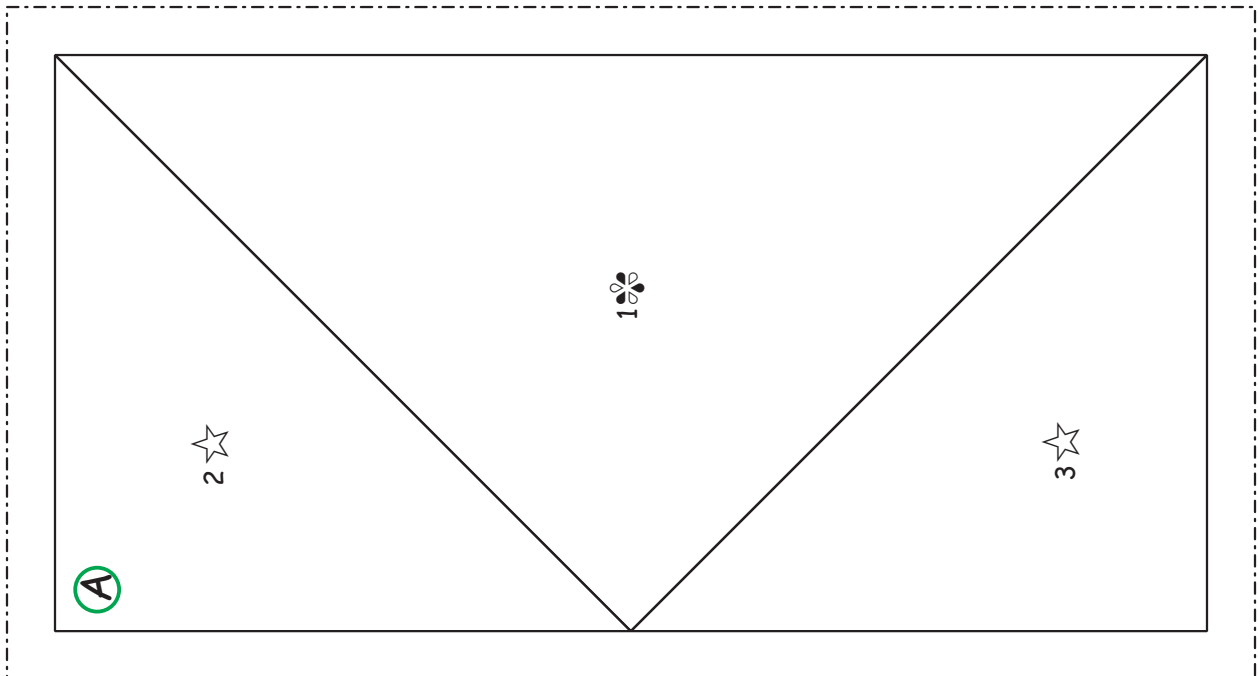
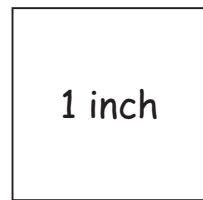



If you prefer to attach the stars points later, work unit D separated.

